

# Prop Guard® Installation Instructions For Volvo Penta Dual Props

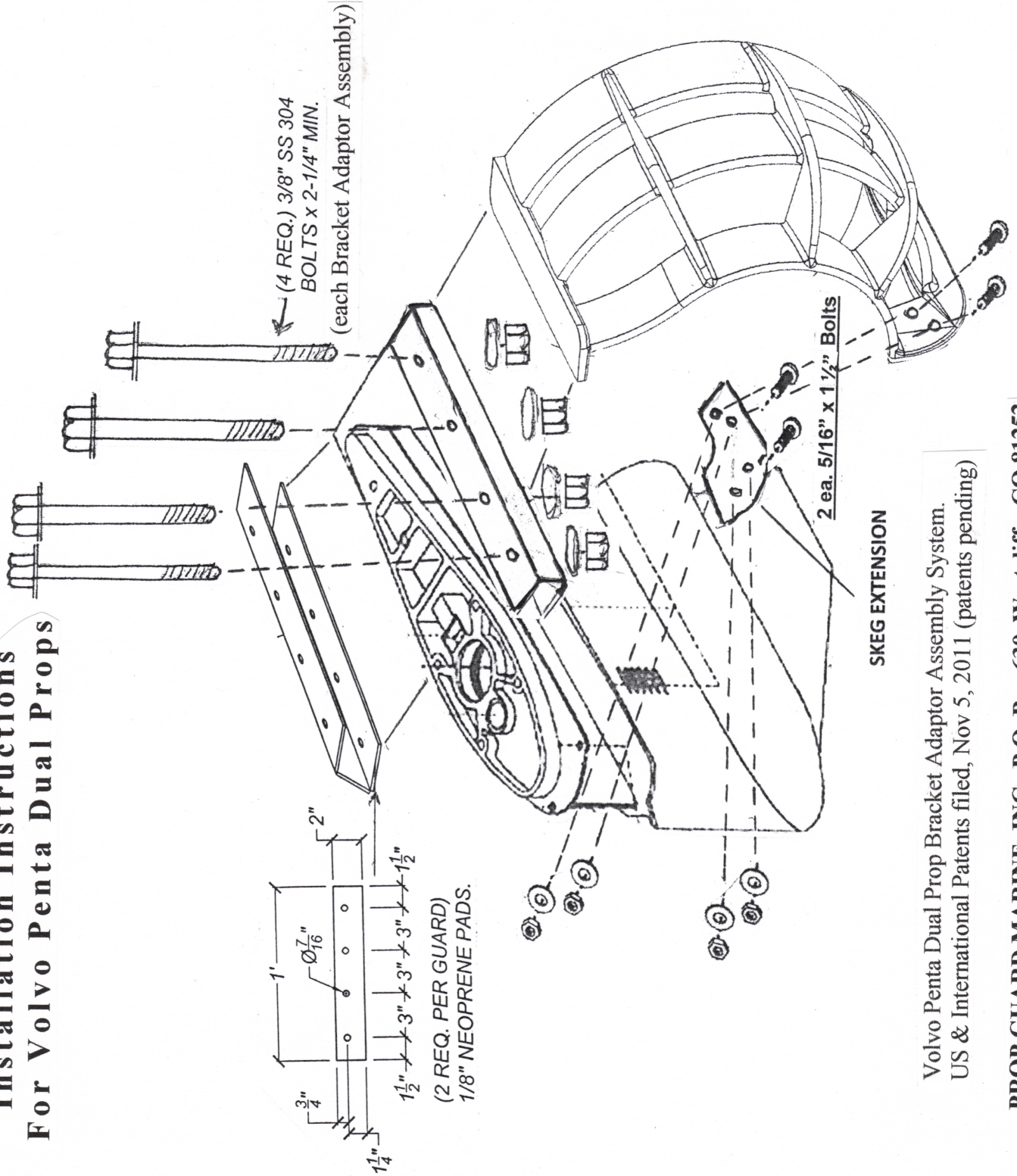

1. Mount skeg extension drilling 2 ea 5/16" staggered holes. Insert Bolts, washers & Nylon nuts & tighten.
2. Clamp the Bracket & Prop Guard to the cavitation plate using C-clamps or Grip clamps. Insert bolts, washers and Nylon nuts through bottom of pre-drilled holes at bottom of rings and loosely tighten.
3. Make certain that the guard is square with the cavitation plate, propeller and lower skeg. **PROPELLER MUST BE SURROUNDED BY THE PROP GUARD. MAY NEED TO SLIDE PROP GUARD (PG) FORWARD OR AFT FOR PROPER PROP CLEARANCE.**
4. Drill 4 holes through the cavitation plate and guard on each side. Insert bolts, washers (on each side of bolts) and Nylon nuts as illustrated and loosely tighten.
5. Drill 2 holes through lower skeg, per illustration. Insert bolt, washer and Nylon nut, tighten securely. Now tighten all your bolts.
6. **REMOVE CLAMPS !!!**  
**EXTREMELY IMPORTANT: MAKE SURE YOUR MOTOR IS TRIMMED TO OBTAIN MAXIMUM PERFORMANCE OF YOUR PROP GUARD®.**

Volvo Penta Dual Prop Bracket Adaptor Assembly System.  
US & International Patents filed, Nov 5, 2011 (patents pending)

**PROP GUARD MARINE, INC., P.O. Box 630, Westcliffe, CO 81252**

2 ea. 5/16" x 1 1/2" Bolts